

COMUNE DI CHIANCIANO

INDICE FAB. 1,5 mc/mq  
 COP. MASS. 1/4  
 ALT. MASS. m 14,0

VARIANTE GENERALE AL P.R.G. SCHEMA EDILIZIO

DENSITA' FONDIARIA 1,5 MC/MQ

VOLUMI DI MISURA LIMITATA

SCALA 1:1000

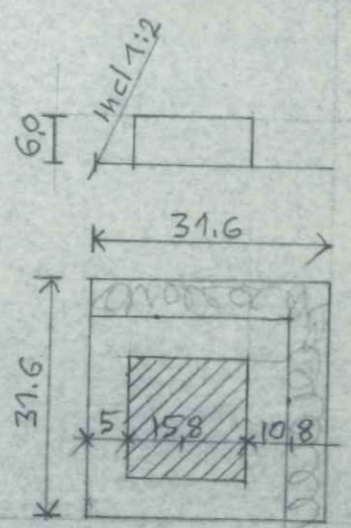

MQ 1,000  
 MC 1,500

COPERT. MASS  
 1/4 = mq 250  
 m 15,8 x m 15,8  
 h = m 6,00  
 verde di alberi ad alto fusto mq 300

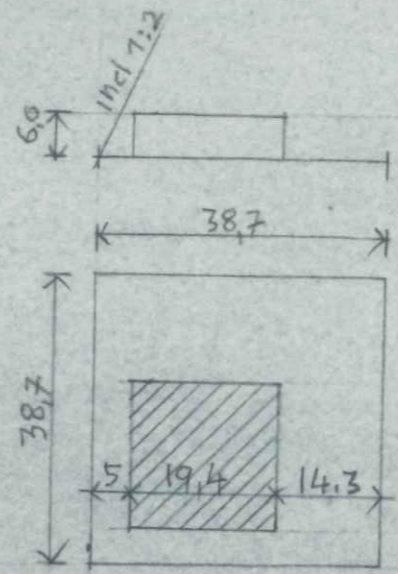

MQ 1,500  
 MC 2,250

COPERT. MASS  
 1/4 = mq 375  
 m 19,4 x m 19,4  
 h = m 6,00  
 verde di alberi ad alto fusto mq 750

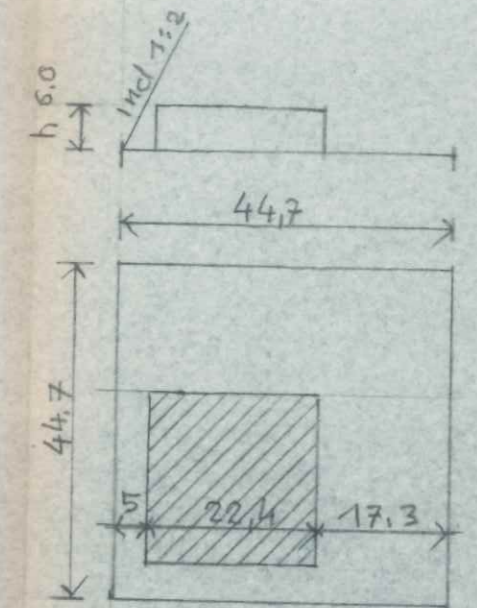

MQ 2,000  
 MC 3,000

COPERT. MASS  
 1/4 = mq 450  
 m 22,4 x m 17,3  
 h = m 6,00  
 verde di alberi ad alto fusto mq 750

SUPERF. LOTTO CUBATURA

MINIMI MQ 1,000 (MC 1,500)\*

MASSIMI MQ 3,000 MC 4,500

\* SONO AMMESSE CUBATURE MINORI FINO A UN LIMITE DI MC 750

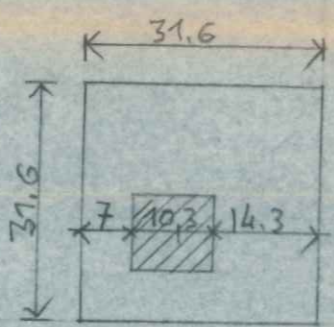
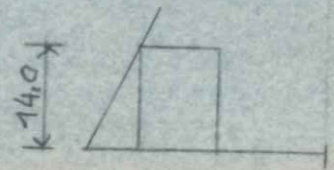

MQ 1,000  
 MC 1,500

h max m 14,00  
 mq 107  
 m 10,3 x m 10,3  
 verde di alberi ad alto fusto mq 300

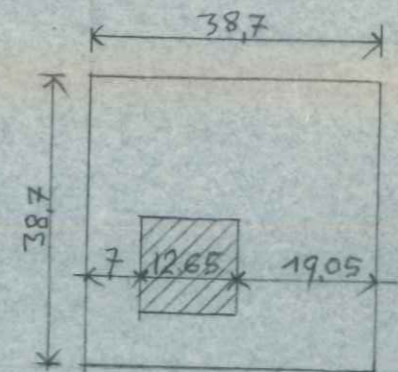
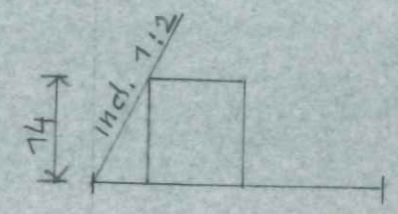

MQ 1,500  
 MC 2,250

h max m 14  
 mq 160  
 m 12,65 x m 12,65  
 verde di alberi ad alto fusto mq 750

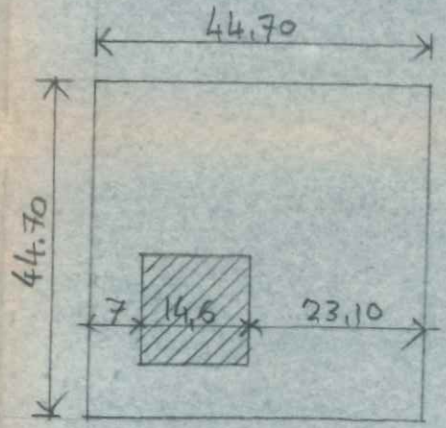
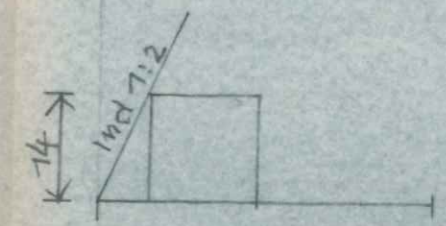

MQ 2,000  
 MC 3,000

h max m 14  
 mq 214  
 m 14,6 x m 14,6  
 verde di alberi ad alto fusto mq 750



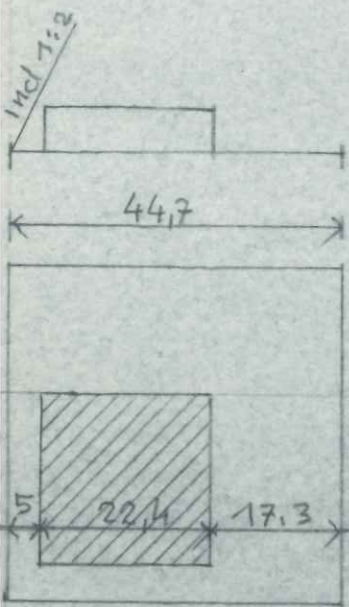

COPERT. MASS.  
 1/4 = mq 500  
 m 22,4 x m 22,4  
 h = m 6,00  
 verde di alberi ad  
 alto fusto mq 600

MQ 2,000  
 MC 3,000

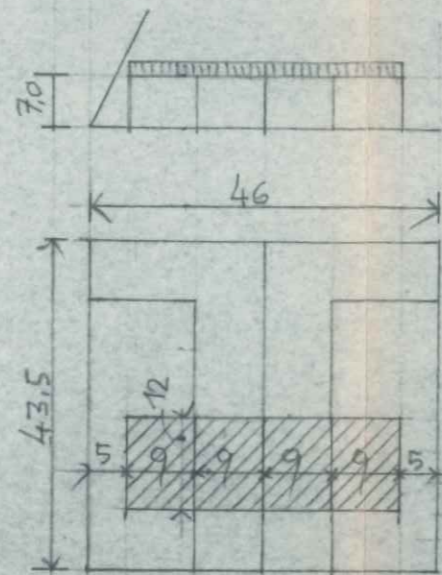

COPERTURA  
 mq 430  
 (m 9 x m 12) x 4  
 h = m 7,0  
 verde di alberi ad  
 alto fusto

MQ 2,000  
 MC 3,000

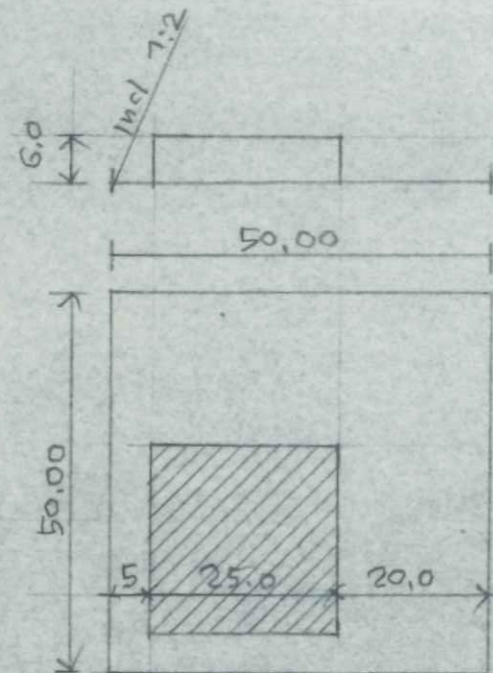

COPERT MASS  
 1/4 = mq 625  
 m 25 x m 25  
 h = m 6,00  
 verde di alberi ad  
 alto fusto mq 750

MQ 2,500  
 MC 3,750

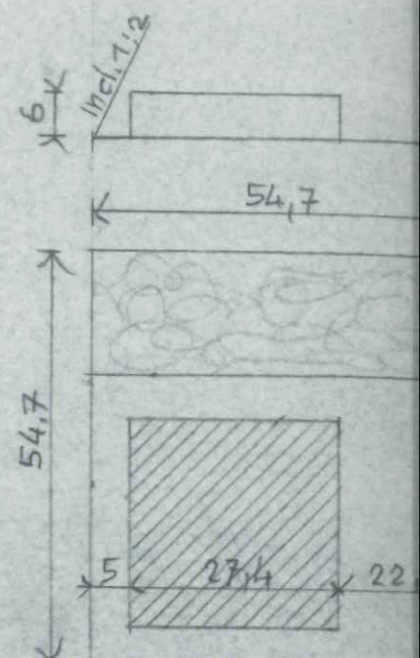

MQ 3,000  
 MC 4,500

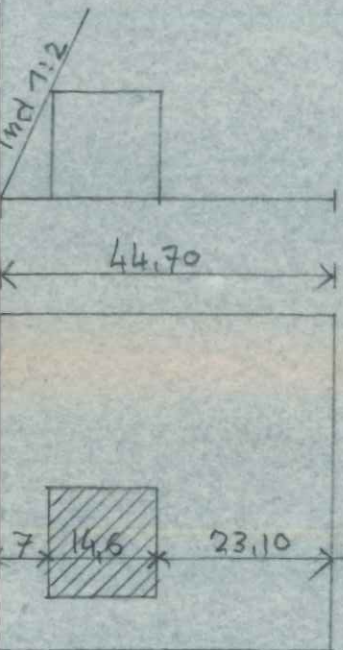

h max m 14,00  
 mq 214  
 m 14,6 x m 14,6  
 verde di alberi ad  
 alto fusto m 600

MQ 2,000  
 MC 3,000

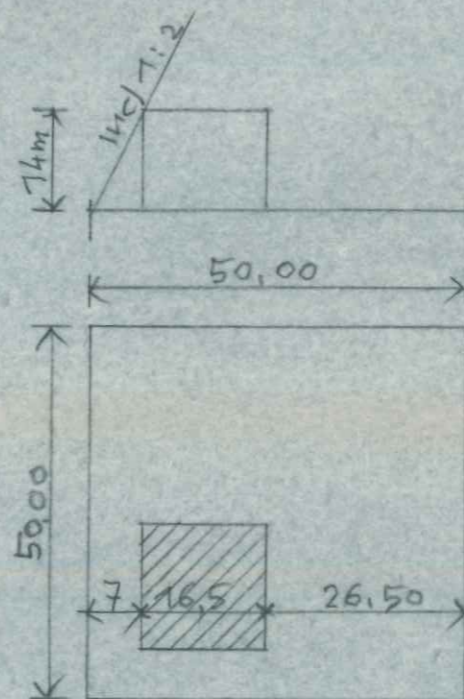

h max m 14,00  
 mq 268  
 m 16,4 x m 16,4  
 verde di alberi ad  
 alto fusto mq 750

MQ 2,500  
 MC 3,750

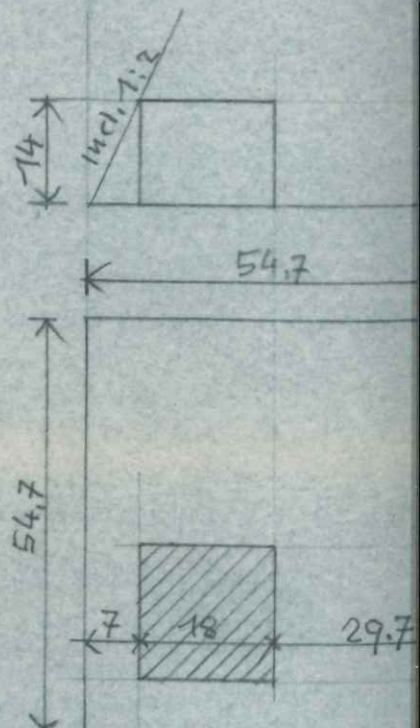

MQ 3,000  
 MC 4,500





COPERT MASS.  
 $1/4 = m^2 750$   
 $m 27,4 \times m 27,4$   
 $h = m 6,0$   
 verde di alberi ad  
 alto fusto  $m^2 900$



$h \text{ max } m 14$   
 $m^2 322$   
 $m 18 \times m 18$   
 verde di alberi ad  
 alto fusto  $m^2 900$

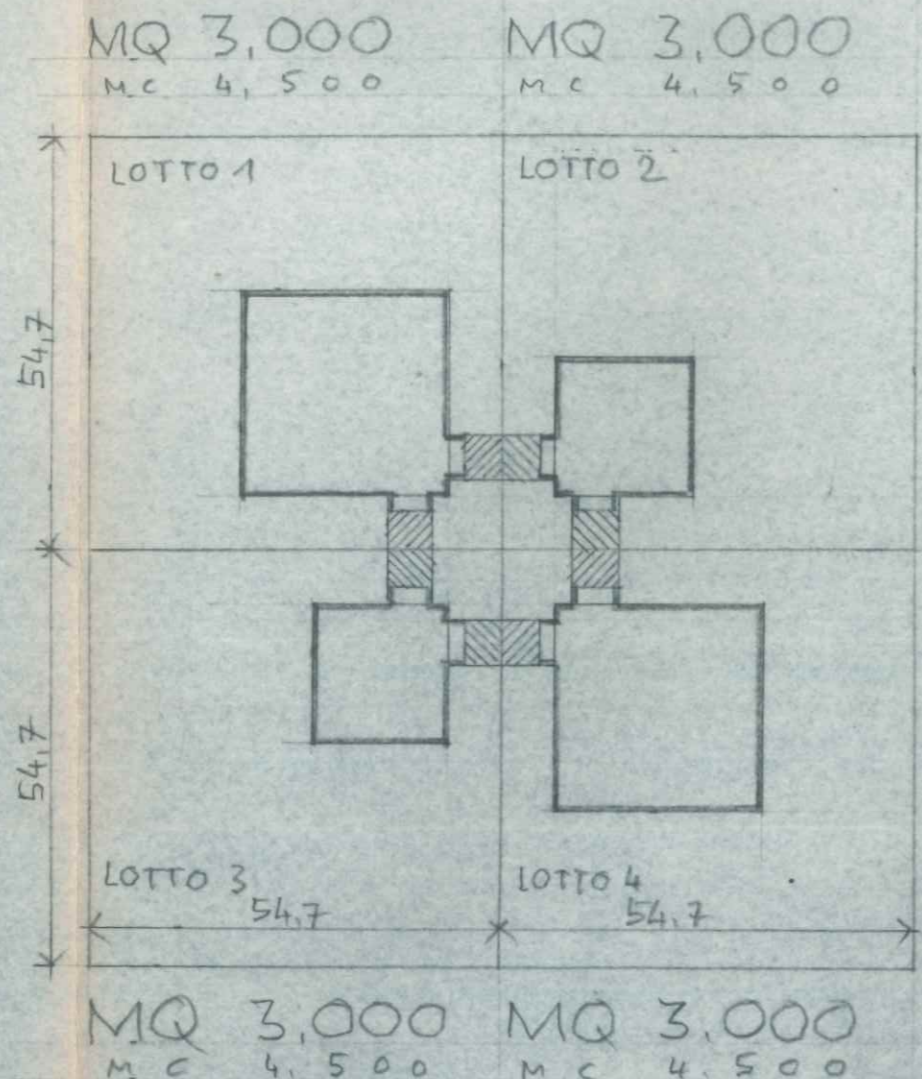

ESEMPIO DI CONGIUNGIMENTO  
 VEDI NOTA SUL DIS. 4.

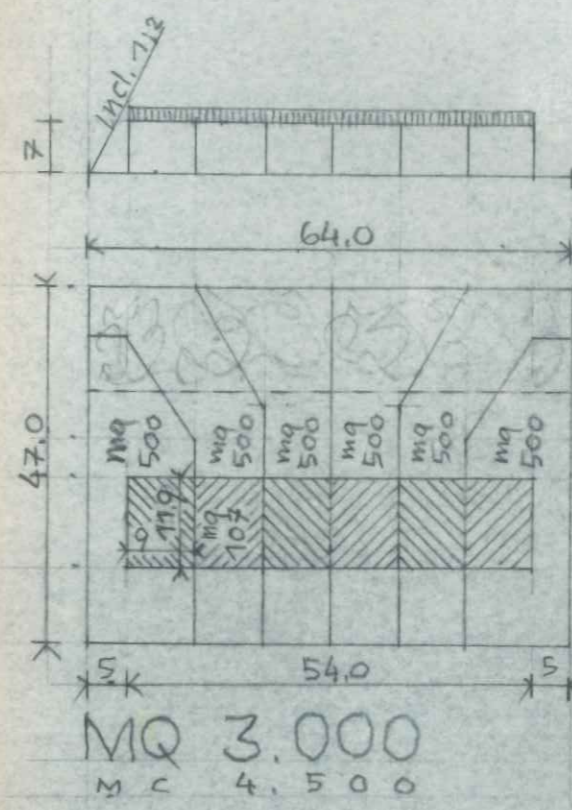

COPERTURA MQ 640  
 $m 9,0 \times m 54,0$   
 6 unita di  $m^2 107$   
 $h = m 7,00$   
 verde di alberi ad  
 alto fusto  $m^2 900$