

DIS. 1<sup>a</sup> art. 11 ZONA I<sup>a</sup> VOLUMI LIMITATI AREE EDIFICABILI INTENSIVE  
 COMUNE DI CHIANCIANO  
 INDICE FAB. 2 mc/mq  
 COP MASS. 1/4  
 ALT. MASS. m 14.0

VARIANTE GENERALE  
 AL P.R.G.  
 SCHEMA EDILIZIO

DENSITA' FONDIARIA  
 2 MC/MQ

VOLUMI  
 DI MISURA  
 LIMITATA

SCALA 1:1000

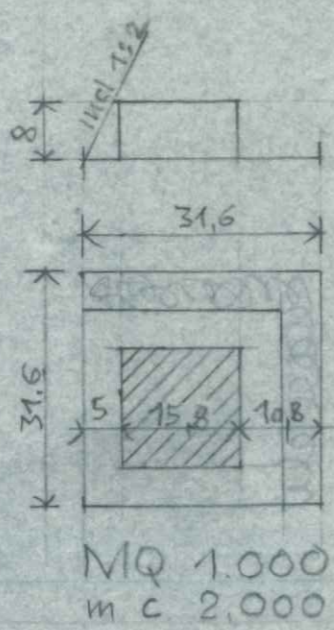

COPERT. MASS  
 1/4 = mq 250  
 m 15,8 x m 15,8  
 h = m 8,0  
 verde di alberi  
 ad alto fusto mq 300

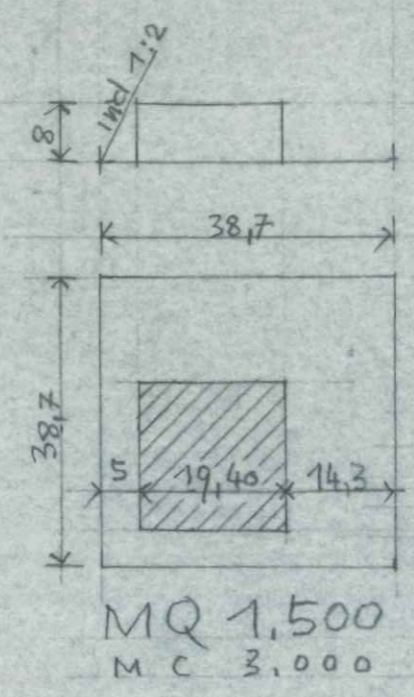

COPERT. MASS,  
 1/4 = mq 375  
 m 19,4 x m 19,4  
 h = m 8,0  
 verde di alberi  
 ad alto fusto  
 mq 450

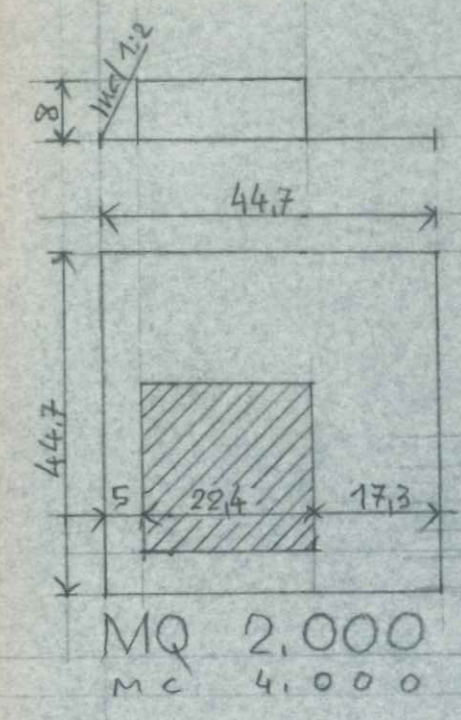

COPERT. M  
 1/4 = mq  
 m 22,4 x  
 h = m 8,  
 verde di  
 ad alto

SUPERF. LOTTO CUBATURA  
 MINIMI MQ 1.000 (MC 2.000)\*  
 MASSIMI MQ 3.000 MC 6.000  
 SONO AMMESSE CUBATURE MINORI  
 FINO A UN LIMITE DI MC 1000

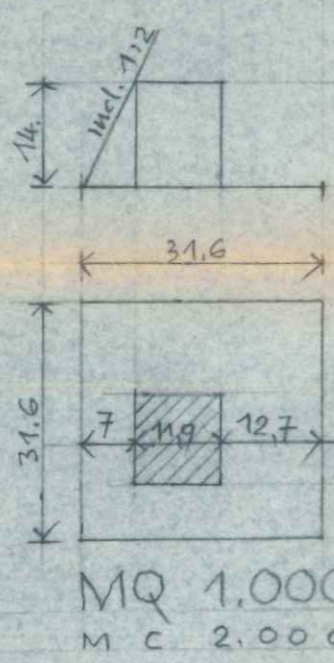

h max m 14  
 mq 142  
 m 11,9 x m 11,9  
 verdi di alberi  
 ad alto fusto  
 mq 300

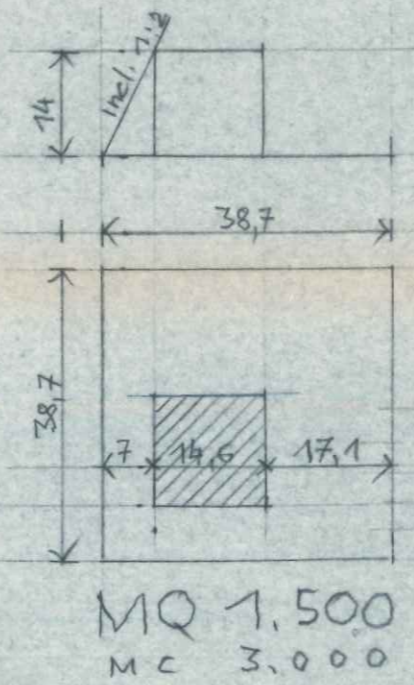

h max m 14  
 mq 213  
 m 14,6 x m 14,6  
 verde di alberi  
 ad alto fusto  
 mq 450

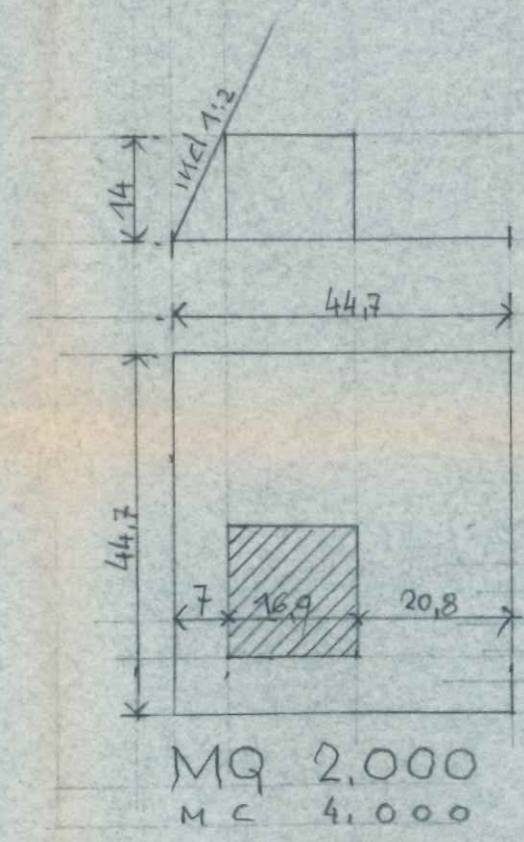

h max  
 mq 285  
 m 16,9  
 verde di  
 alto fusto

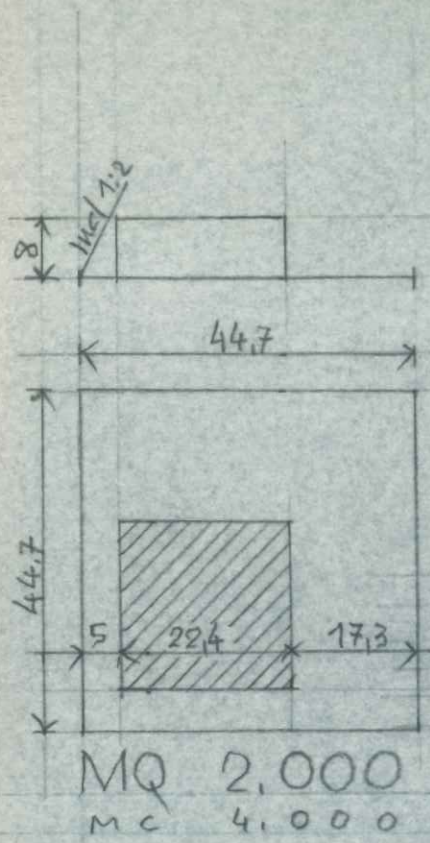

COPERT. MASS.  
 1/4 = mq 500  
 m 22,4 x m 22,4  
 h = m 8,0  
 verde di alberi ad  
 alto fusto  
 mq 600

MQ 2,000  
 MC 4,000

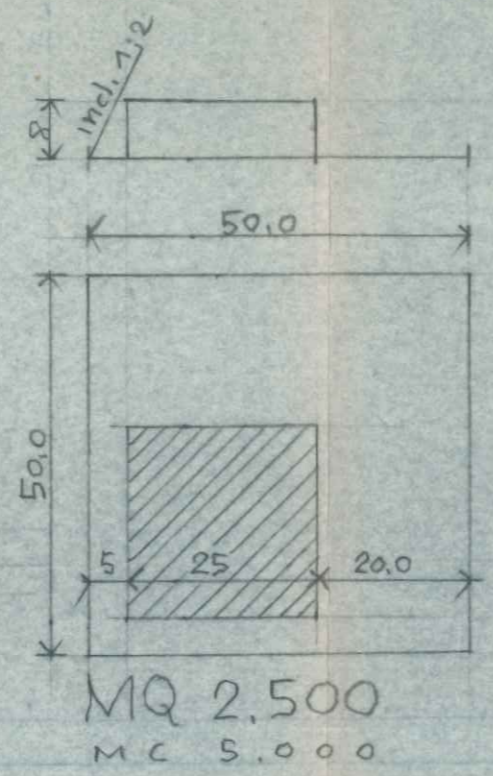

COPERT. MASS.  
 1/4 = mq 625  
 m 25 x m 25  
 h = m 8,0  
 verde di alberi ad  
 alto fusto mq 750

MQ 2,500  
 MC 5,000

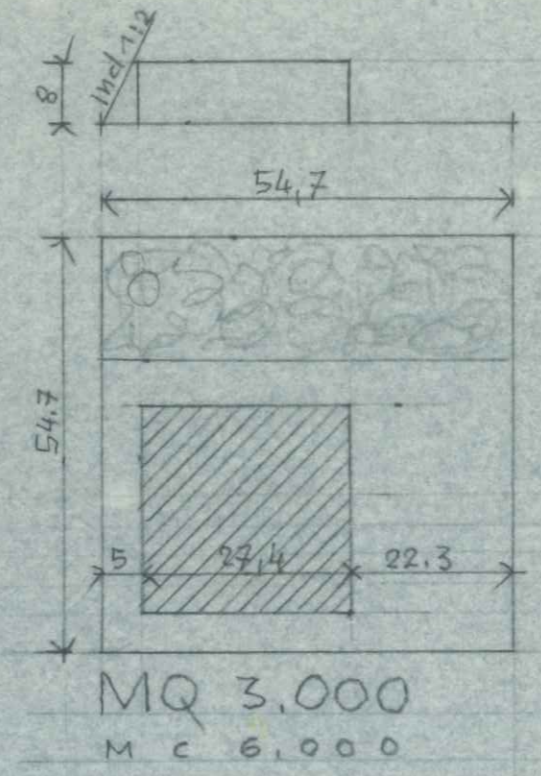

COPERT MASS.  
 1/4 = mq 750  
 m 27,4 x m 22,3  
 h = m 8,0  
 verde di alberi ad  
 alto fusto mq 900

MQ 3,000  
 MC 6,000

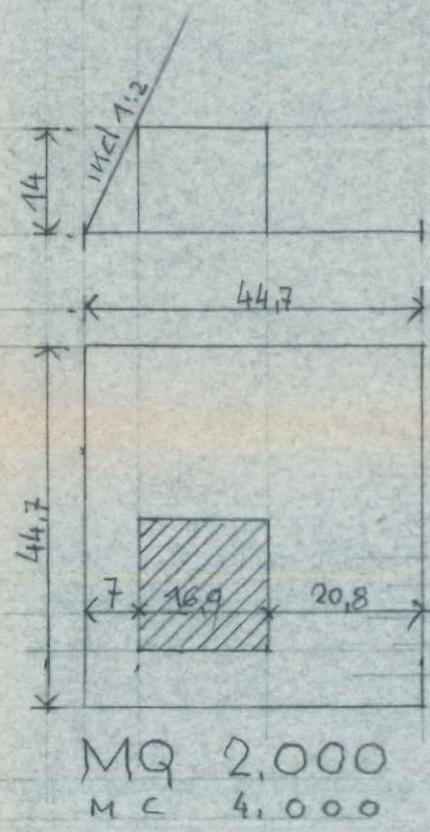

h max m 14,0  
 mq 285  
 m 16,9 x m 16,9  
 verde di alberi ad  
 alto fusto mq 600

MQ 2,000  
 MC 4,000

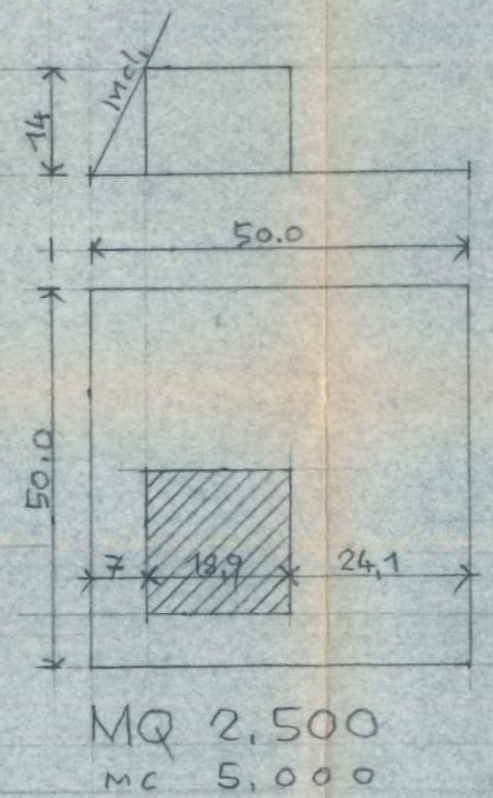

h max m 14  
 mq 356  
 m 18,9 x m 18,9  
 verde di alberi ad  
 alto fusto mq 750

MQ 2,500  
 MC 5,000

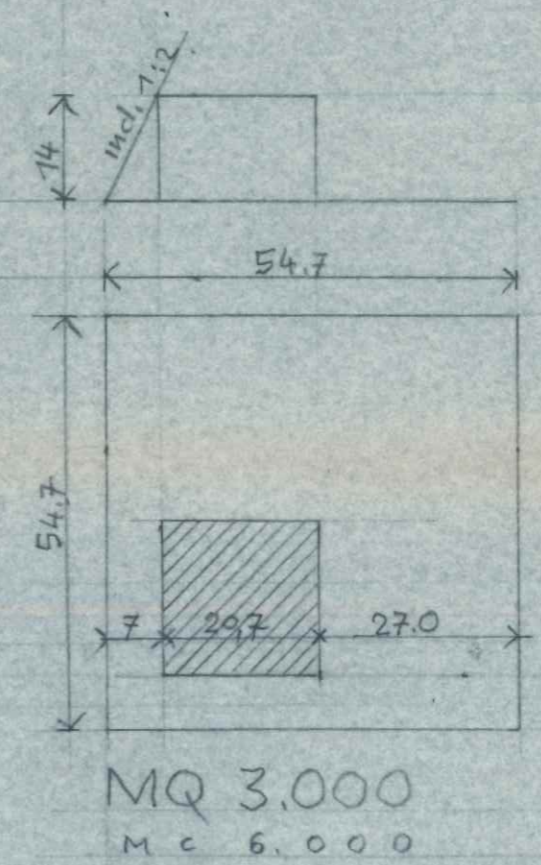

h max m 14  
 mq 430  
 m 20,7 x m 20,7  
 verde di alberi ad  
 alto fusto mq 900

MQ 3,000  
 MC 6,000

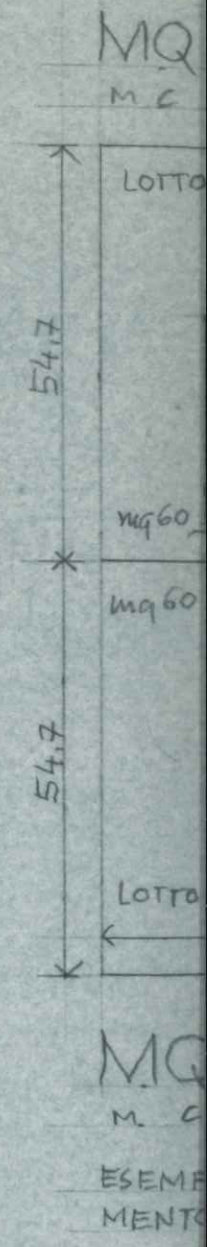

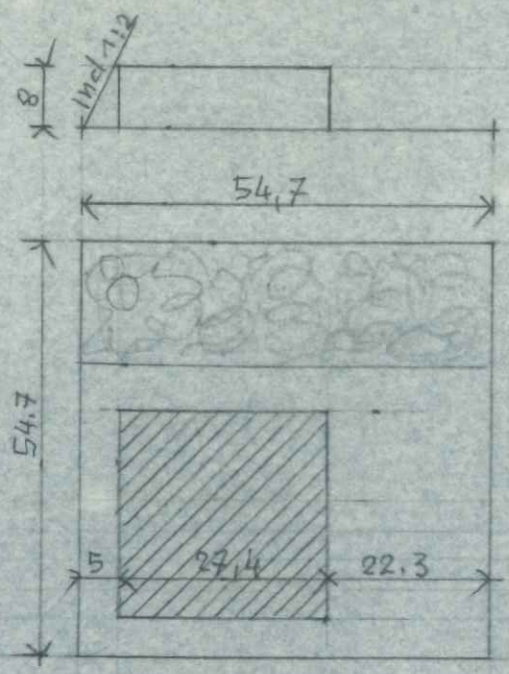

COPERT MASS.  
 1/4 = mq 750  
 m 27,4 x m 27,4  
 h = m 8,0  
 verde di alberi ad  
 alto fusto mq 900

MQ 3,000  
 M C 6,000

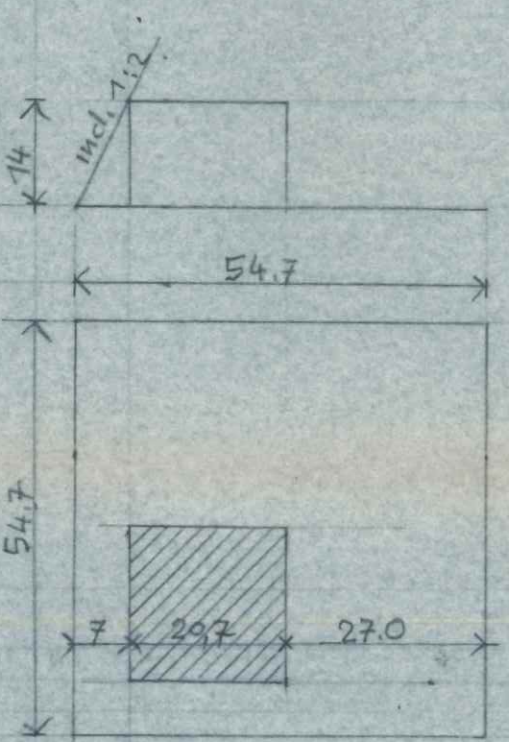

h max m 14  
 mq 430  
 m 20,7 x m 20,7  
 verde di alberi ad  
 alto fusto mq 900

MQ 3,000  
 M C 6,000

MQ 3,000  
 M C 6,000

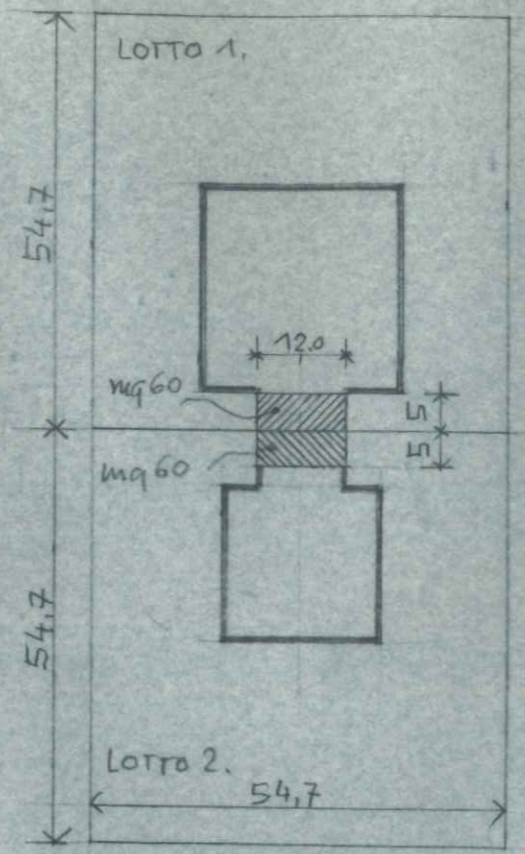

MQ 3,000  
 M C 6,000

ESEMPIO DI CONGIUNGI-  
 MENTO. VEDI NOTA SUL  
 DIS. 4.

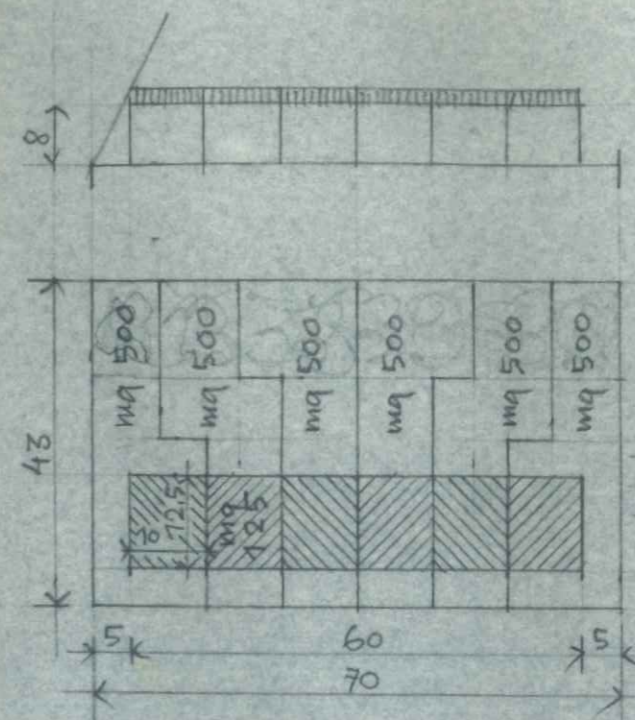

COPERT MASS.  
 1/4 = mq 750  
 m 12,50 x m 60,00  
 h = m 8,00  
 verde di alberi ad  
 alto fusto mq 900

MQ 3,000  
 M C 6,000